

Eden Palace au Lac★★★★★

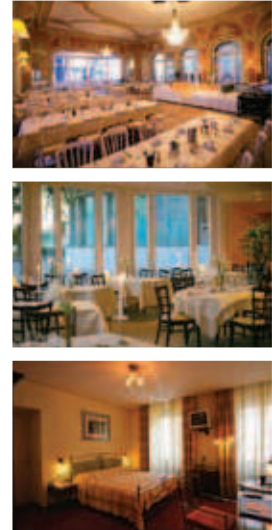

Our Unique selling points

- Right in the city center and away from the hustle bustle, the Eden Palace au Lac is an epitome of the "Belle Epoque" style.
- Complimentary In-room High Speed Internet Access and 50 movies on demand
- "My Royal Bed" mattress for ultimate nights comfort

Our location

- Centrally located near the shopping centre and the Casino Barrière of Montreux
- 10 minutes walking distance from the train station and the Montreux Music & Convention Centre

Our Style & architecture

- Built in 1896, the Eden Palace au Lac is a "Belle Epoque" style palace

Our rooms

- 94 rooms, 9 Junior suites, 1 Executive suite
- 60% of lake view rooms & some non smoking rooms

Our Food & Beverage outlets

- Chez Gaston: fine dining room with Mediterranean style cuisine and Lounge-Bar
- Amazing terrace with 250 seats, right on the lake side

Our Wellness facilities

- Outdoor swimming pool, fitness and sauna. Free access to the Spa (indoor swimming pool, sauna, fitness and hammam) of our partner, The Grand Hotel Excelsior

Our other facilities

- 1 "Belle Epoque" banquet room with a breathtaking view over the lake
- 1 Modular conference centre with day light and free WIFI Internet Access
- 4 other function rooms with day light and free Internet Access

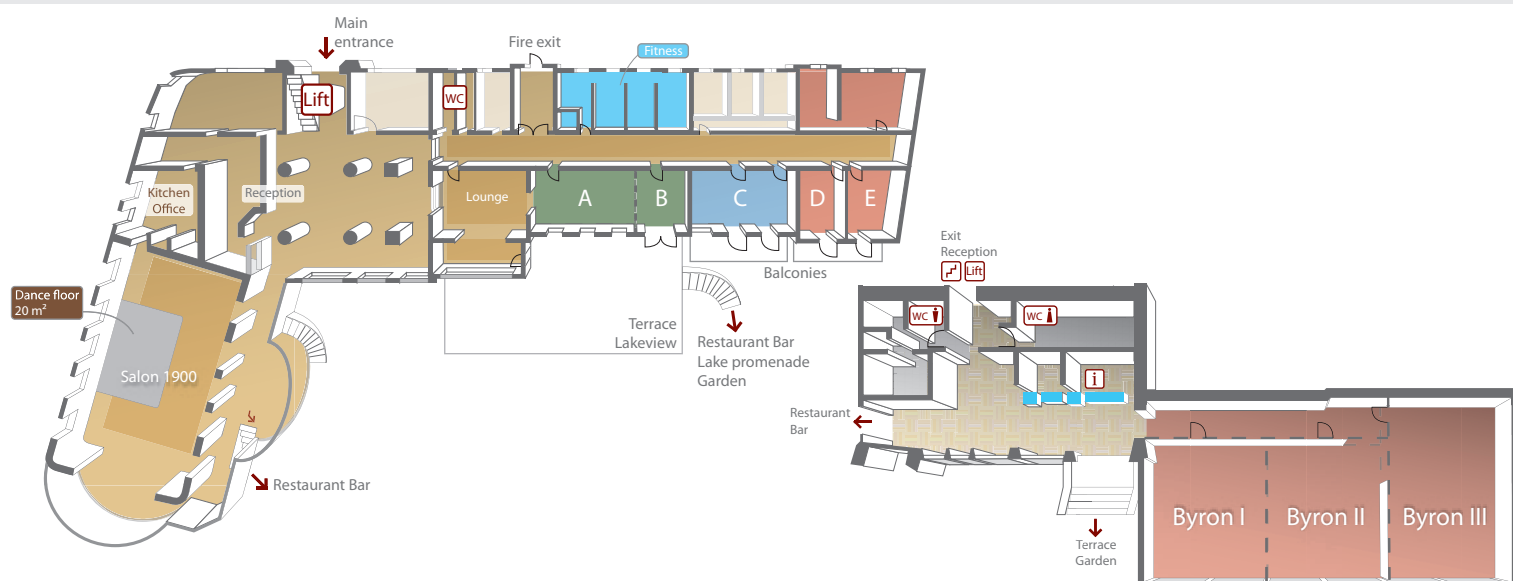

	Theatre	Classroom	Reception	Banquet	Boardroom	Area m²	Dimensions	Height	Floor
Victoria (A)	45	30	60	25	25	42	8.5 x 4.9	3	2
Régence (B)	10	-	15	-	8	21	4.4 x 4.9	3	2
Victoria + Régence	55	40	75	40	32	63	12.9 x 4.9	3	2
Léman (C)	30	20	40	-	20	40	8 x 5	3	2
Room D	-	-	-	-	10	17.5	3.5 x 5	3	2
Room E	-	-	-	-	10	17.5	3.5 x 5	3	2
Salon 1900	-	-	300	200	-	340	-	5.5	2
Byron I	60	30	60	50	30	50	6.4 x 7.8	3	1
Byron II	60	30	60	50	30	50	6.5 x 7.8	3	1
Byron III	60	40	-	60	30	81	8.1 x 10	3	1
Byron I + II + III	200	120	250	200	90	210	21 x 10	3	1

